

Environmental

SEPTIC & WASTE SERVICES, INC.

P.O. BOX 466
Damascus, MD 20872

SEPTIC SYSTEM INSPECTION REPORT

Office: 301-253-1400
301-258-8813
Fax: 301-253-4021

Date: 2/1/2007

www.seekseptic.com

Address of System Inspected:

Street: 1880 Woodbine Rd. City: Woodbine
County: Howard State: MD Zip: _____

Septic Tank:

Tank Construction: Cement Tank Seam: Mid-Seam
Tank Compartment: One Compartment
Manhole Access: Yes Manhole Cover: Ground Surface
Is there a Depression Where Runoff Water Collects? No
Tank Integrity (Evidence of Infiltration or Leakage)? No
Liquid Level: Normal Inlet Baffle/"T": Acceptable
Capacity: 1,200 Gallons Outlet Baffle/"T": Acceptable
Tank Pumped? Yes
Tank Comments: Fill dirt should be put around the septic tank.

Disposal Field

Wet Areas: No Liquid Discharges: No Unknown Discharge Pipes: _____
Dead Vegetation: No Green or Lush Vegetation: No _____
Does the Tank Drain to Drainage Field Properly? Yes
Is there a Distribution Box? unknown
Drainage Field Comments: _____
Septic System Comments: The home has been vacant, abnormal water usage has entered the septic system.

Signature of Certified Inspector

2-1-07

Date

Name of Inspector:

Vernon King III

Septic systems are subterranean, therefore, it is impossible to determine their overall condition. Also, when no water is entering the field lines, i.e., if the house is vacant, a determination of their status is difficult. No prediction can be made as to when or if a system might fail. This report comments on the workability of the system on the day of the inspection only, and is in no way intended to be a warranty. Workability can be altered by factors such as excessive rainfall, heavy water usage, faulty plumbing, neglect or physical damage to the system. Please consult the county Health Dept. for any future replacement or percolation testing of the septic system. All tanks require regular pumping maintenance.

Call for annual cleaning

SEPTIC RECORDS AND MAINTENANCE GUIDELINES

(Vernon)

Thomas H. Miller

Proper design, installation, and maintenance of your septic system will maximize your system's life. It will prevent failures that can be unsightly, foul-smelling, and threatening to your family's health. Good maintenance reduces the risk of contaminating your well water, and may save you from costly repairs or system replacement.

This folder contains information that will help you maintain your septic system properly. It also provides a convenient place for you to record and file information about your system. Keep it with other important documents in your home, and pass it on to future owners. Septic tank inspection may be required by lenders when you sell or refinance your home. The repair of a failing system is usually a cost to the seller. So, ignoring your septic system will not save money in the long term.

Green lid do not cover

How Your System Works

A septic system has two major components: a septic tank and a drainfield.

Septic Tank (Figure 1): Wastewater sewage flows from the house to the septic tank. The tank is designed to retain wastewater and allow heavy solids to settle to the bottom. These solids are partially decomposed by bacteria to form sludge. Grease and light particles float, forming a layer of scum on top of the wastewater. Baffles are installed at the inlet and outlet of the tank to slow the water movement and prevent the scum and solids from escaping.

Newer septic tanks can have a partial concrete dividing wall in the center, thus making two compartments. This helps

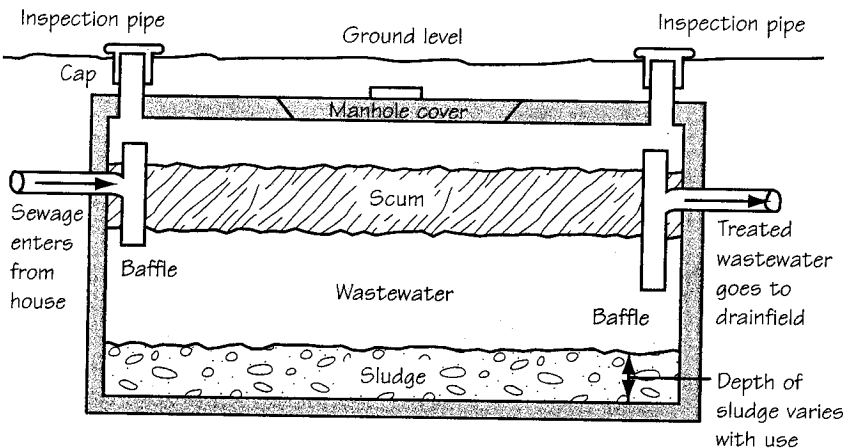

Figure 1. Illustration courtesy of the Maryland Department of the Environment.

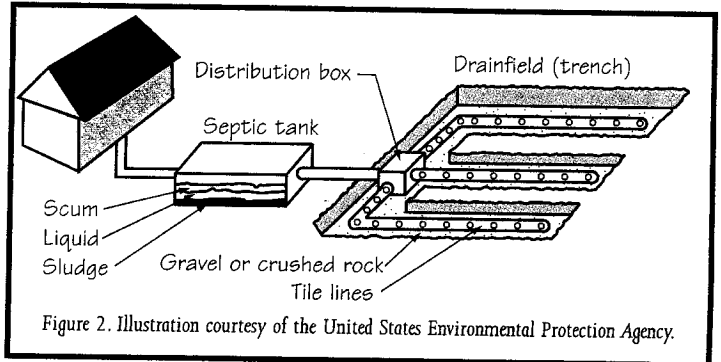

Figure 2. Illustration courtesy of the United States Environmental Protection Agency.

ensure the sludge does not get forced out of the baffle into the drainfield. Newer tanks can also have two manhole covers, one above each baffle.

Drainfield (Trench) (Figure 2): A solid pipe leads from the septic tank to a distribution box where the wastewater is channeled into one or more perforated pipes set in trenches of gravel. Here the water slowly infiltrates (seeps) into the underlying soil. Dissolved wastes and bacteria in the water are trapped or adsorbed to soil particles or decomposed by microorganisms that occur naturally in the soil. These processes remove disease-causing organisms, organic matter, and most nutrients (except nitrogen and some salts). The purified wastewater then either moves to the groundwater or evaporates from the soil. Trench systems are the most common type of system used in new home construction.

PUB. SEWER STATUS VERIFIED BY _____

ISSUE DATE: 7/21/05

APPROVAL DATE: 8/29/05

PERMIT
INDEXED
04328728

P 522982

A REPAIR

ON-SITE SEWAGE DISPOSAL SYSTEM
HOWARD COUNTY HEALTH DEPARTMENT
BUREAU OF ENVIRONMENTAL HEALTH

Fogles Septic Clean, Inc IS PERMITTED TO INSTALL ALTER

ADDRESS: 580 Obrecht Road PHONE NUMBER: 410-795-5670

SUBDIVISION: _____ LOT NUMBER: _____

ADDRESS: 1880 Woodbine Road PROPERTY OWNER: Earl Stevens

SEPTIC TANK CAPACITY (GALLONS): 2-Comp. Trench 3' Wide

PUMP CHAMBER CAPACITY (GALLONS): N/A Inlet 3.5'

NUMBER OF BEDROOMS: 3 Bottom 4.5'

SQUARE FEET PER BEDROOM: 210 1' Stone Below Pipe

LINEAR FEET OF TRENCH REQUIRED: 175 2 Trenches

| | |
|-----------|---|
| TRENCHES: | Trench to be _____ feet wide. Inlet _____ feet below original grade. Bottom maximum depth _____ feet below original grade. Effective area begins at _____ feet below original grade. _____ feet of stone below distribution pipe. |
| LOCATION: | <u>Pump Out and Fill in Old Tank and Drywell</u> |
| PURPOSE: | Existing septic system has failed. Call for inspection when ground is opened so sanitarian can recommend repair. |

PLANS APPROVED: _____ DATE: _____

NOTE: PERMIT VOID AFTER 2 YEARS

NOTE: CONTRACTOR RESPONSIBLE FOR SCHEDULING A PRE-CONSTRUCTION INSPECTION FOR ALL INSTALLATIONS

NOTE: WATERTIGHT SEPTIC TANKS REQUIRED

NOTE: ALL PARTS OF SEPTIC SYSTEM SHALL BE 100 FEET FROM ANY WATER WELL

NOTE: MANHOLE RISERS REQUIRED ON ALL SEPTIC TANKS AND PUMP CHAMBERS

NEITHER THE HOWARD COUNTY COUNCIL OR THE HEALTH DEPARTMENT IS RESPONSIBLE FOR THE SUCCESSFUL OPERATION OF ANY SYSTEM PERMITTEE RESPONSIBLE FOR OBTAINING FINAL APPROVAL ON THIS PERMIT CALL 410-313-2640 FOR INSPECTION OF SEPTIC SYSTEM

P 522982

NOT TO SCALE

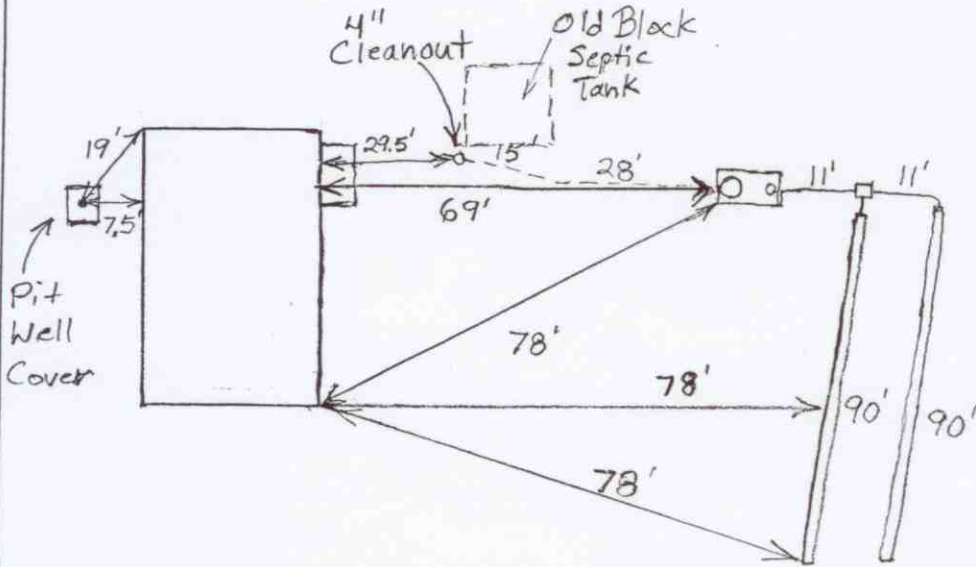

| TRENCH/DRAINFIELD DATA | | |
|-------------------------|-------|-----------------|
| WIDTH | INLET | BOTTOM |
| 3' | 3.5' | 4.5' |
| NUMBER OF TRENCHES | | 2 |
| TOTAL LENGTH | | 180' |
| ABSORPTION AREA | | 540' + Sidewall |
| DISTRIBUTION BOX LEVEL | | Levelers |
| DISTRIBUTION BOX BAFFLE | | Yes |
| DISTRIBUTION BOX PORT | | No |

| SEPTIC TANK DATA | |
|---------------------|-----------|
| SEPTIC TANK 1 LEVEL | Yes |
| CAPACITY | 1500 GAL |
| SEAM LOC | Top |
| TANK LID DEPTH | 0.5'-1.5' |
| BAFFLES | Yes |
| BAFFLE FILTER | No |
| MANHOLE LOC | Front |
| 6" PORT LOC | Rear |
| WATERTIGHT TEST | No |
| SEPTIC TANK 2 LEVEL | N/A |
| CAPACITY | _____ GAL |
| SEAM LOC | _____ |
| TANK LID DEPTH | _____ |
| BAFFLES | _____ |
| BAFFLE FILTER | _____ |
| MANHOLE LOC | _____ |
| 6" PORT LOC | _____ |
| WATERTIGHT TEST | _____ |

Babylon
2-Comp.

PRE-CONSTRUCTION 8/24/05 To install a new 2-compartment septic tank and 175' of trench near the perc test hole.

INSTALLATION Keep tank 100' from well. (BB)

8/25/05 Drywell filled with dirt. Setting tank. (BB)

8/26/05 Old tank filled in. Starting with trenches. Gave installer O.K. to deepen trenches by up to 1' if not getting through upper clay layer. (BB) 8/29/05 Installer put trenches in at original depth. He said that the material looked good. O.K. to backfill. (BB)

FINAL INSPECTOR B. Baker

DATE OF APPROVAL 8/29/05

SEPTIC SYSTEM REPAIR / UPGRADE / EVALUATION REQUEST

Please fill out this form completely and check off the reason for the request:

Date requested: _____

Reason for Request

Failing System (includes surface discharge or inadequate treatment zone)

Has the contractor verified through excavation/pumping evaluation, that there are no pipe blockages?

In support of a _____ existing addition: _____

*System relocation for setback compliance _____

*Verification of COMAR 26.04.02.02D (4) _____

To replace collection line for capacity _____

To replace collection line _____

Septic Contractor: Fogle's Septic

Contractor's Address: 580 Obrecht Rd

Sykesville

Contractor's Phone #: 410 795-5670

Property Address: 1880 Woodbine Rd

Property (Subdivision) & Lot # _____

Owner's Name: Earle Stevens

Is public sewer available/nearby: No

Names of Any Previous Owners: 1

Year House Built: 1953

of Existing Bedrooms: 3

of Bedrooms after completion of addition: _____

Has this request been discussed previously with a Sanitarian, who? _____

If public sewer is close, further research will be performed to verify availability and possible hook up to public sewer.

A Sanitarian will be in contact within three business days depending upon the urgency of the situation to coordinate the scheduling of the repair /upgrade/evaluation. No inspection will be performed without fee collection at the office.

Environmental Sanitarian tentatively assigned _____

A/P (A)

3' Red Br
Si Cl Loam
15-20% Rock

8.5' Red Br
Sa Loam
30-40%
Decaying
Rock

11.5' ~70%
Decaying
Rock

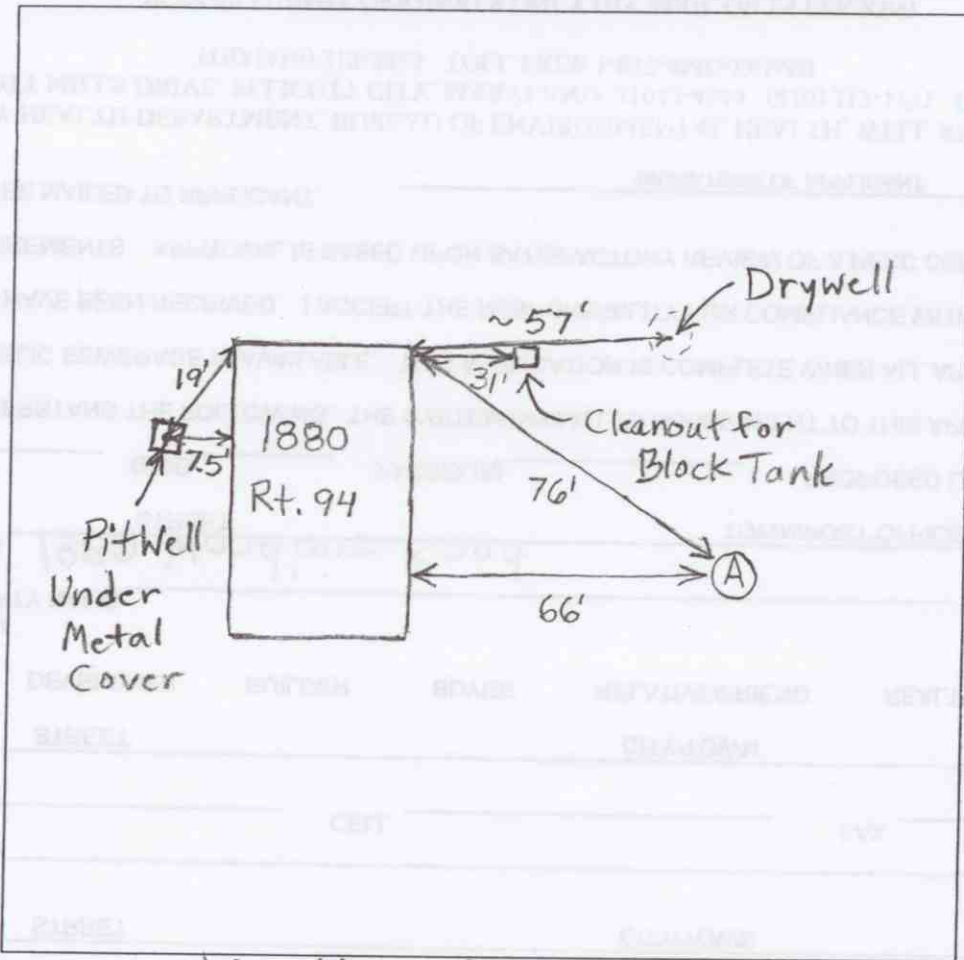

Woodbine Road

| DATE | TEST # | DEPTH | START | BREAK 1" DROP | STOP 2" DROP | TIME OF 2nd INCH | P/F/H |
|---------|--------|----------|-------|------------------|-----------------|---------------------|-------|
| 8/24/05 | A | 4'/11.5' | 10:44 | 10:50:30 | 11:04 | 13 1/2 | P |
| | | | | | | | |
| | | | | | | | |
| | | | | | | | |
| | | | | | | | |
| | | | | | | | |
| | | | | | | | |
| | | | | | | | |
| | | | | | | | |
| | | | | | | | |

REMARKS Water Poured in Bottom of Hole -

SANITARIAN B. Baker BACKHOE Fogles OTHERS Earl Stevens

TEST HOLES USED IN SDA A AVG. PERC TIME 13 1/2 SQ. FT/BR 210

TRENCH WIDTH 3' INLET DEPTH 3.5' MAX. BOT DEPTH 4.5' EFFECTIVE SW 1'